

---

# **Installation manual Mirrorlink interface**

## **Designed for Apple & Android devices**

**Article number:**

**HDMI-WIFI2**

---

## Content

1: IMPORTANT INFORMATION .....	2
2: INBOUW- & VEILIGHEIDS INSTURCTIES .....	3
3: SCOPE OF DELIVERY .....	3
4: COMPATIBILITEIT .....	4
5: WIRE DIAGRAM .....	5
7: INSTALLATION .....	8
8: WARRANTY .....	23
9: TECHNICAL DATA .....	23
10: TECHNICAL SUPPORT .....	23

## **1: IMPORTANT INFORMATION**

You have made the right choice by purchasing advanced NavInc multimedia products. We recommend to read the installation instructions carefully before starting the installation.

Installation must be done by a qualified personnel. Installation of the interface is entirely at your own risk. We accept no liability for damage to the vehicle or personal injury. If the manual is not well enforced and / or the interface is incorrectly connected, the guarantee claim as well the operating permission becomes invalid.

The guarantee claim as well the operating permission becomes invalid due to:

- a) The housing is opened*
- b) The warranty sticker is damaged or broken*
- c) The interface is damaged*
- d) Capital repairs are performed*
- e) Cable / connector is modified*
- f) Brute force to the device*

The operation of this interface may be affected by software updates from the manufacturer / dealer. In such cases, within one year of purchase, we provide a free software update for the multimedia interface. The costs for removal and de/re-installation is not included and the interface must be supplied to us.

In the supplied (service) instructions you can specify how and where the products are installed. In addition, end users are made aware of important addresses that he can consult in case of questions or problems. We advise you and the end-user to give the service record to the dealer when maintenance must be done.

Warranty must be done via a RMA request. Returns without (copy) invoice, RMA form and RMA number will not be accepted. Returns can only be sent after agreement RMA request.

General Guidelines for Maintenance:

- a) For repair / maintenance end-user must always show the Service instructions to the dealer.*
- b) If the vehicle goes to a dealer for service, it may be necessarily that the interface module (s) must be temporarily removed due to a software update or reading failures.*
- c) In this case, the loop-through adapters (optional) can be used to remove easily the interface modules.*

NavInc thank you for your choice and wish you lots of media fun!

## 2: INBOUW- & VEILIGHEIDS INSTRUCTIES

Installation must be done by a qualified personnel.

Do not install this interface by yourself. For safe and reliable installation, consult a dealer having special knowledge.

- *Use the device only at a +12 volt vehicle electrical system. Make sure to have a proper ground.*
- *The device should not be set up in direct proximity of heat sources (e. g. power amplifier).*
- *Please make sure that no objects or liquids can intrude the interior of the device! (Danger of short circuit!)*
- *Please follow all caution advises contained in the mounting guidelines.*
- *Please read through all safety instructions and handling directions intently before installation and start up of the device.*
- *Check alway the compatibility of the interface for your car before installation. You can check the compatibility on [www.navinc.nl](http://www.navinc.nl) or call NavInc for support.*
- *Avoid installing the unit in following places: Where it would hinder your safe driving – Where it could damage the car's fitting.*
- *Make sure the power is fused with 7A or 10A fuses.*
- *Please check all the car functions after installing the interface.*
- *Make sure the end customer can always reset the interface. You can reset the interface to make it powerless.*

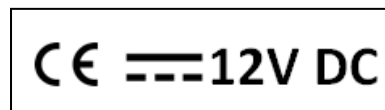

### **3: SCOPE OF DELIVERY**

Scope of delivery

Package:

1. Cable kit multi: 1x
2. Installation instructions: 1x

### **4: COMPATIBILITEIT**

#### **Car models**

The interface is compatible for at the following Smartphone's with Miracast option:

IOS

Android

Please check [www.navinc.nl](http://www.navinc.nl) for more details

## 5: WIRE DIAGRAM

### 5.1 Overview

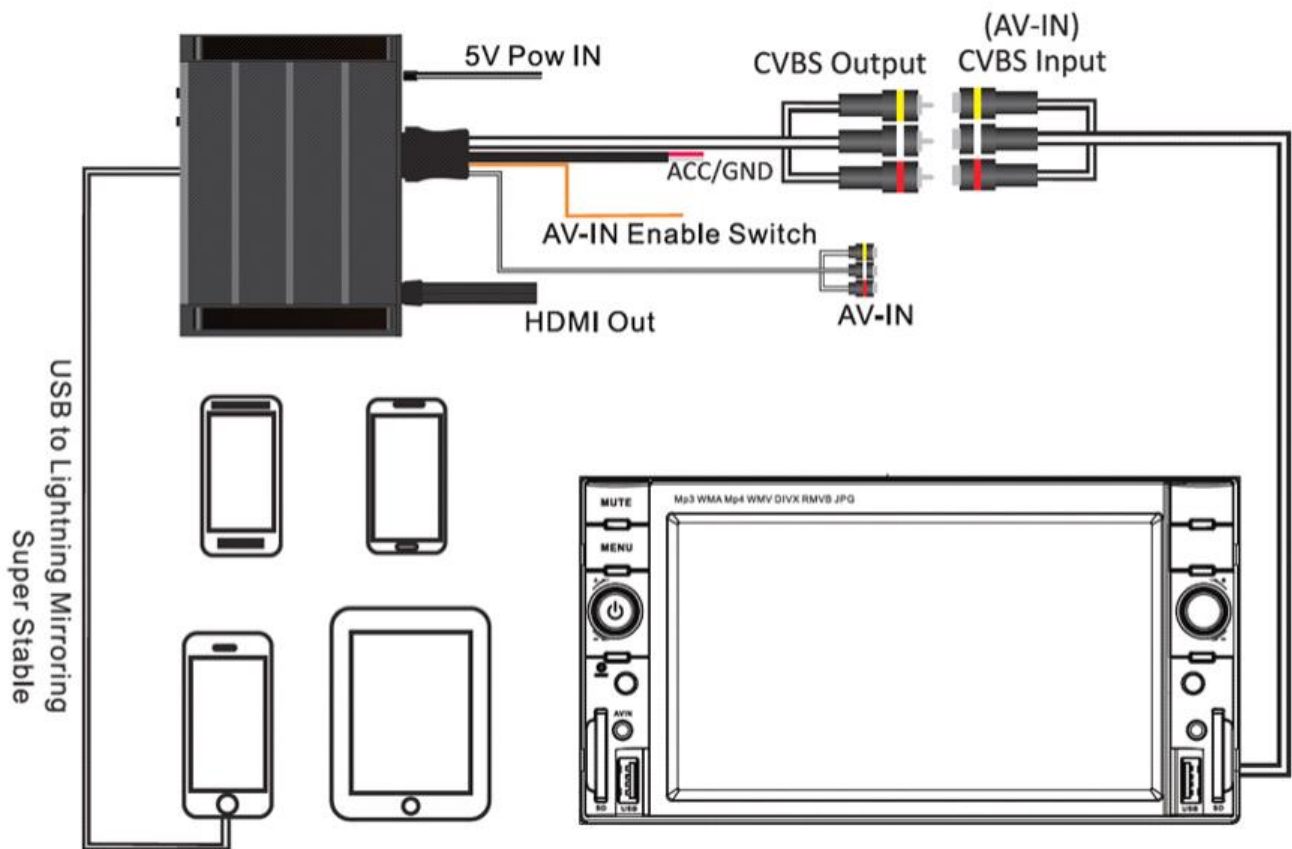

### 5.2 Specificatios interface

<b>Power Input:</b>	DC12V/DC5V
<b>Power Consumption:</b>	Idle status:200mA Without WiFi Connection
<b>Working Status:</b>	500mA With WiFi Connection
<b>Wi-Fi Standard:</b>	Wi-Fi 802.11 b/g/n
<b>Input:</b>	WiFi Airplay/Miracast/ Dlna Extra AV-IN(CVBS)
<b>Output:</b>	Car Audio AUX/AV-IN(CVBS)...+HDMI
<b>Temperature Range:</b>	—20°C~70°C
<b>Humidity:</b>	0°C~90°C

## 5.3 Interface

### RESET

Press and hold for 1 second = reset interface

Press and hold for 5 seconds = back to factory settings

### SERVICE

For service only

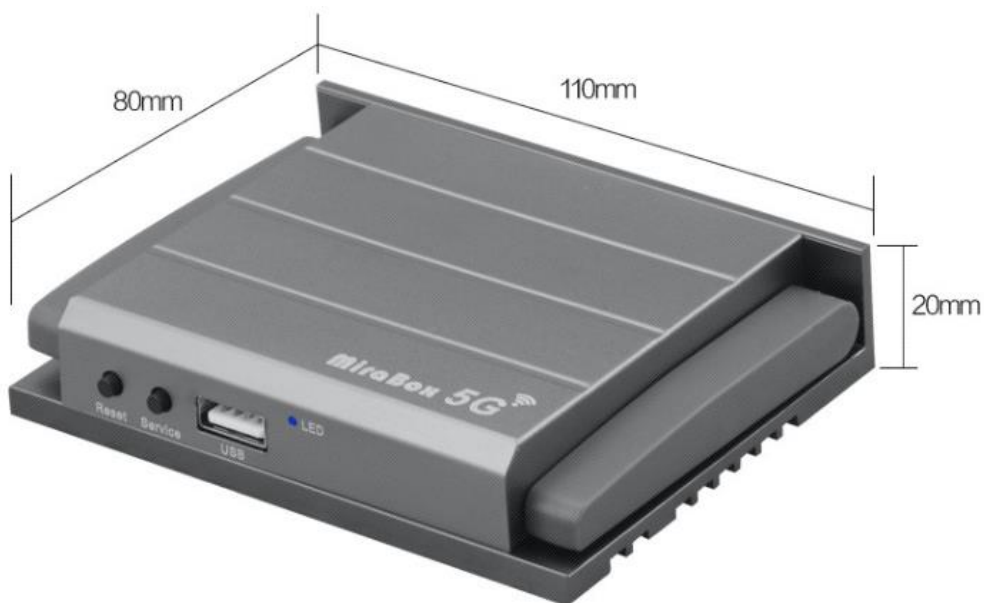

---

## 6: REQUIREMENTS

- 1: Check if the interface is compatible with your phone.
- 2: When you receive this package you have to check whether there's any parts not included and you have to contact us right away.
- 3: Get the right installation tools



## 7: INSTALLATION

### 7.1 Power

**Attention; do not install the interface when the ignition is ON.**

1: Connect the ACC & GND wires (12V):

- Red +12V ignition feed (+15)
- Black Ground (GND)

2: It is also possible to feed the interface via "PWR IN" input (5V).  
(cable not included)

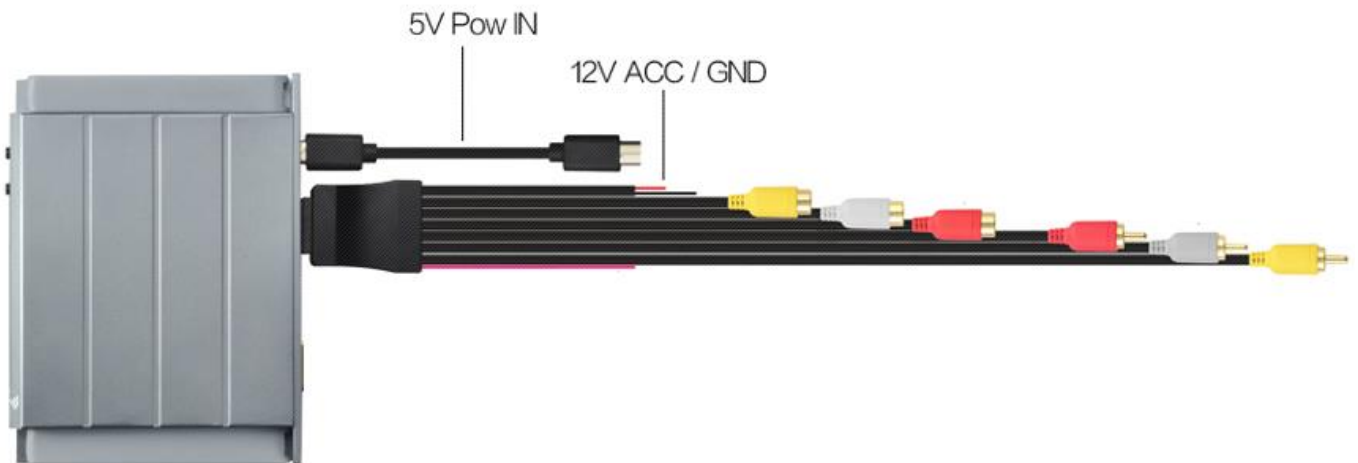

*\*Do not connect both 5V & 12V feed at the same time.*

## 7.2 IN- & OUTPUTS

### AV-OUT

Connect the male RCA plugs (AV-OUT) from the power cable with the car or head-unit.

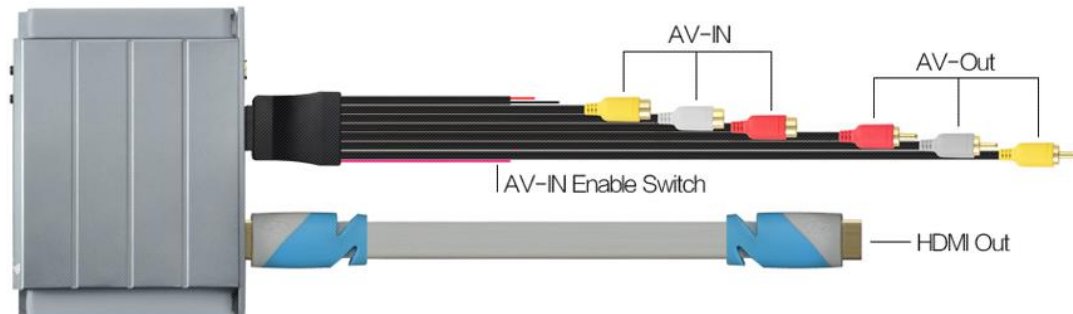

- \*Output is NTSC
- \*Not compatible with PAL systems
- \*Use a ground loop filter when you have engine noise.

### HDMI OUT

Connect the HDMI cable with the interface “HDMI OUT” and your car or head-unit (cable not included).

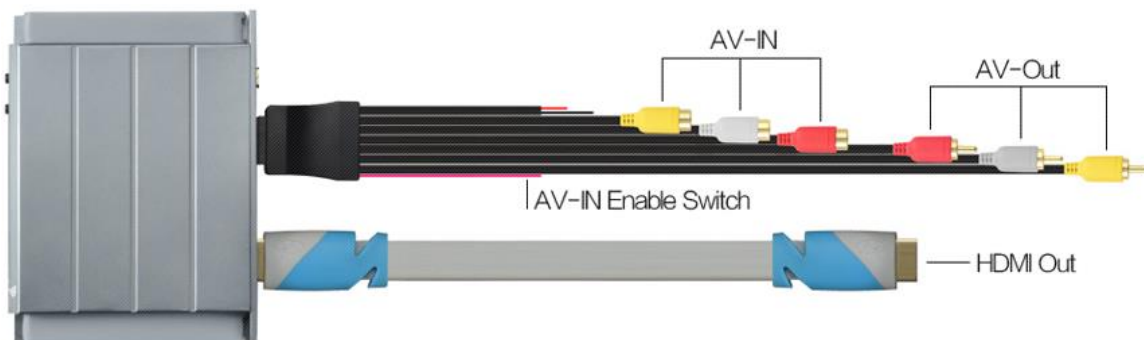

- \*Output is NTSC
- \*Not compatible with PAL systems
- \*Output max 1080P

## AV-IN

Connect the female RCA plus (AV-IN) with the external source.

You can use the red wire (AV-IN Enable Switch) to change the input:

Power ON 12V = external AV-IN

Power OFF = Mirrorlink

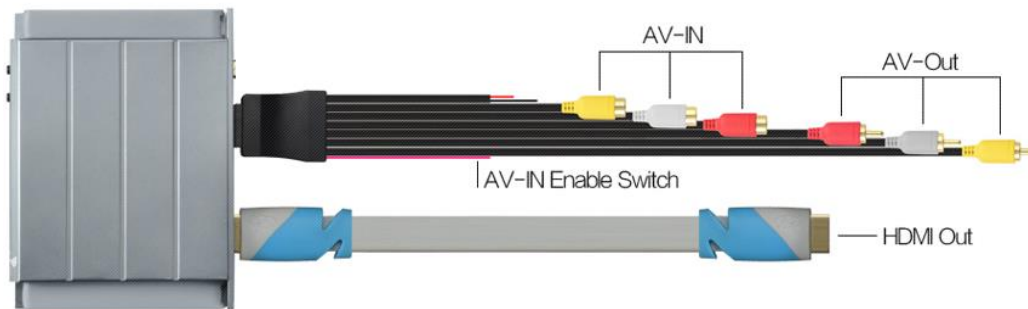

## USB

### Firmware upgrade

You can update the systems firmware via the USB input.

### Loading

You can charge your phone via the UBS input (max 1A output)

### Mirroring

You can Mirrorlink your Apple devices via lightning cable

## 7.3 Connecting with Apple device

1: Go to settings – Wi-Fi and select “HotSpot”.



2: Put your finger on the button of the screen and swipe upwards and select AIRPLAY.

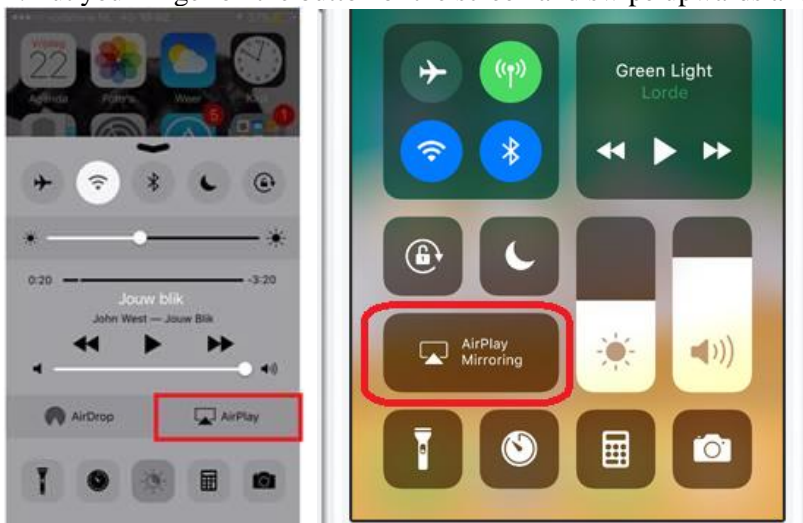

3: Select “HotSpot” and “Synchron” and press “Done”



## 7.4 Connecting with Android device

### Samsung Galaxy S3, S4, S5, S6, Note2, Note3, Note4, etc.

1: Select “Screen Mirroring”.



2: Select “Screen Mirroring”.

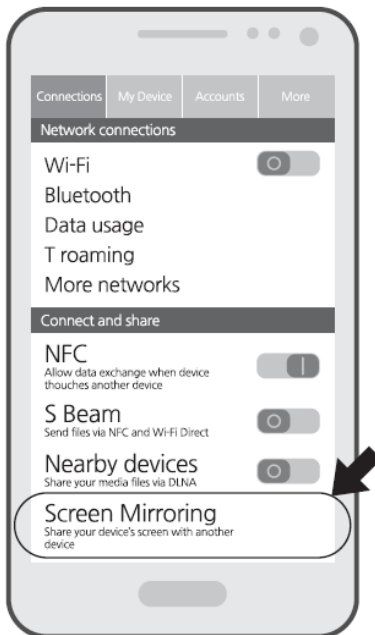

3: Search with Wifi devices (takes about 5 seconds) & select “HotSpot”.



## LG Optimus G, G Pro, G2, G3, G4, etc.

1: Select “Share & connect”.

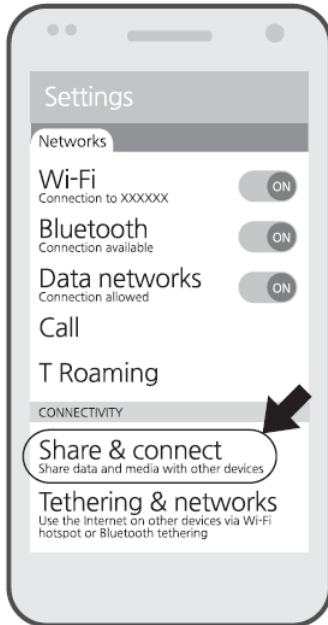

2: Select “Miracast” and put this in ON position.

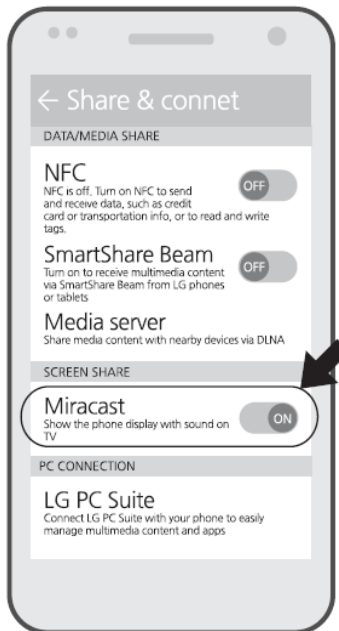



3: Search with Wifi devices (takes about 5 seconds) & select “HotSpot”.



## Samsung Galaxy S6 Edge

1: Put your finger in the top and swipe downwards to enter the fast menu. Press the button “fast connection”.



2: Select “HotSpot”.



### 3: Select "Smart View (screen mirror)"



## HTC M8 & M9

### 1: Select “Settings”

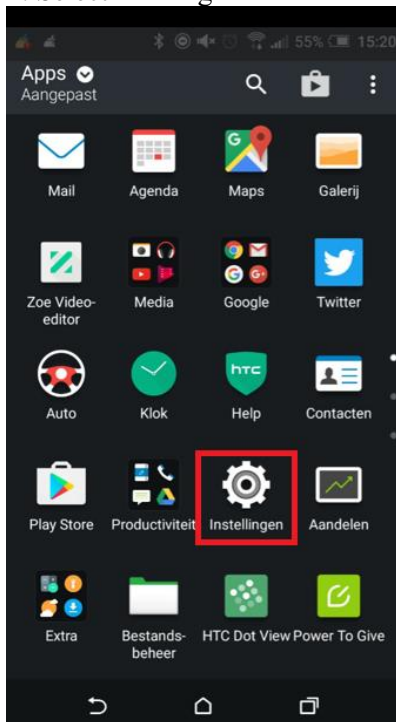

### 2: Select “HTC Connect”

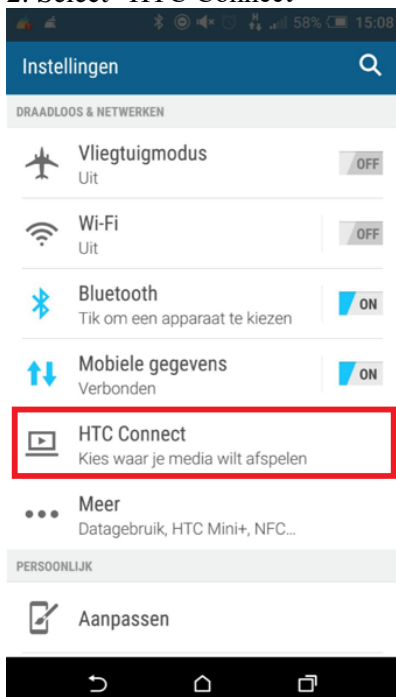

### 3: Select "HotSpot"

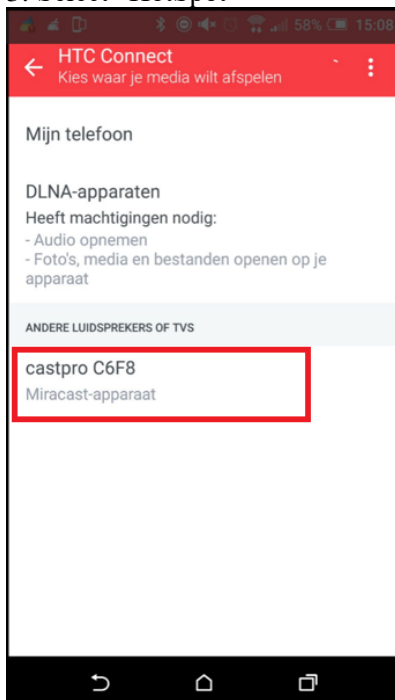

## 7.5 Connecting Apple device via USB

- 1: Connect the lightning cable with the USB port.
- 2: Select “Trust this computer”
- 3: Put “Cellular” in ON position.
- 4: Keep “Personal HotSpot” in “ON” position
- 5: Select “Bluetooth and USB Only” when Wi-Fi in OFF position.
- 6: Put your finger on the button of the screen and swipe upwards and select AIRPLAY.

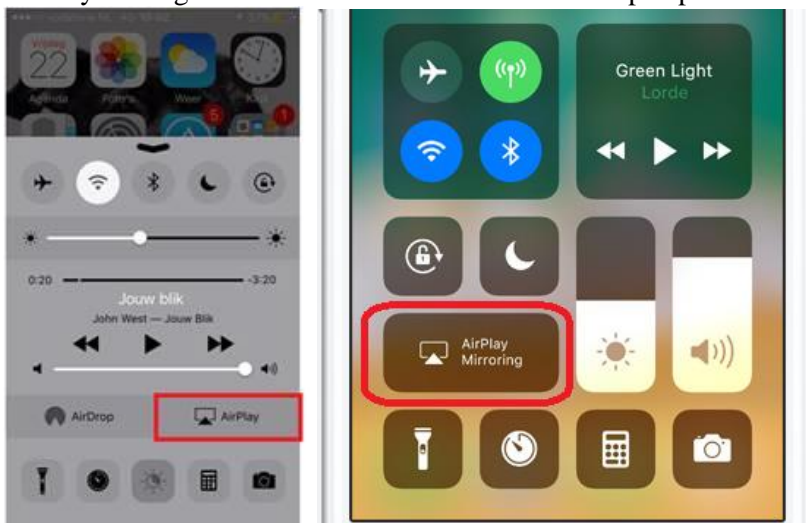

## 7.6 Update

Take the following steps to update the system:

1: Unpack the update file and put this on a empty USB stick (FAT32).

Naam	Gewijzigd op	Type	Grootte
 install.img	28-8-2017 18:00	Schijfkopiebestand	53.453 kB

2: Connect the USB stick with the Mirrorlink box.

3: The update will start automatically when you put ignition ON,

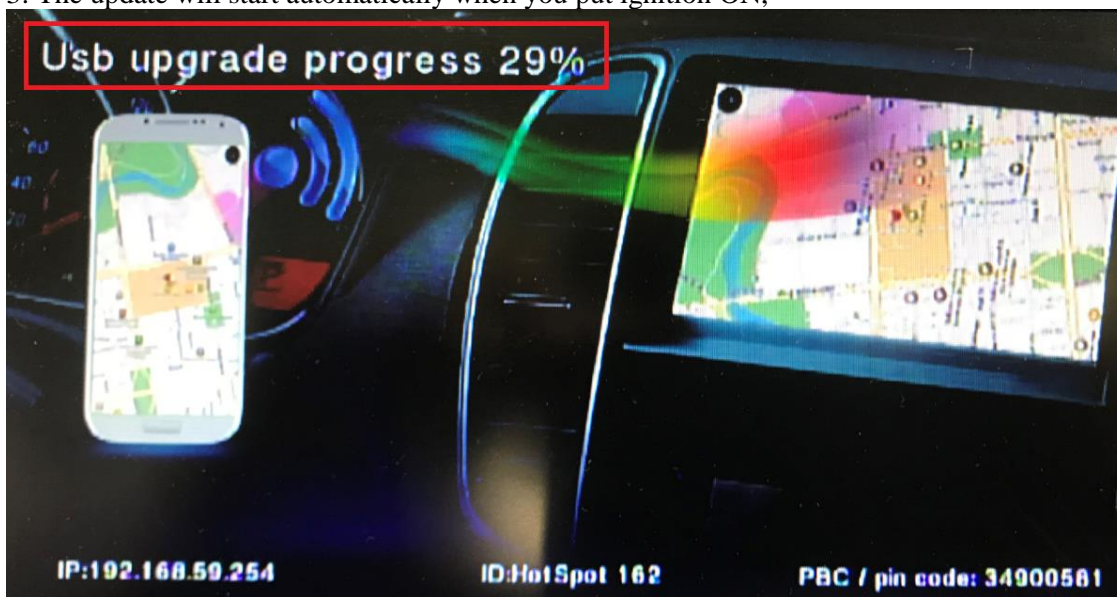

4: The mirrorlink box will reboot. When mirrorlink is rebooted please put ignition OFF and disconnect the USB stick.

5: Put ignition ON. The Mirrorlink box will start and finish the update. .

## 8: WARRANTY

The product is designed for automotive use and his environment. The warranty of the product is one year.

No warranty:

- not break the labels attached on the board.
- Damaged of the interface
- Own reperation
- Modified cables

## 9: TECHNICAL DATA

Software version:	SW1.0
Voltage supply:	5V DC & 12V
Voltage-operating capacity:	10,5 – 14,8 V
Standby current:	0 mA
Operating current:	500 mA
Wifi Standards:	IEE802 11(b/g/n, 2.4 + 5 Ghz)
HDMI Standards:	HDMI 1.3
Operating temperature:	0 - 90 degrees
Dimensions W x H x D:	110mm x 80mm x 20mm

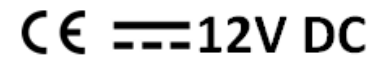

## 10: TECHNICAL SUPPORT

All our products are manufactured under strict quality control. Each device is being tested before shipment. If nevertheless do occur problems or if you have technical questions, contact us directly under:

<b>Distribution by:</b>	<b>NavInc</b>
<b>Technical support email:</b>	<b>info@navinc.nl</b>
<b>Technical support tel:</b>	<b>0031 (0)40 7511912</b>

In addition to constant product update and development related changes the instruction manuals of the devices are constantly edited and kept up to date.

To enable us to provide you with the right information and support for the device you have got at hand please add the following information to every inquiry:

Date of purchase, your name and address, item number and the type of your vehicle.